



Series/Serie

**N**

**ROTARY UNIONS FOR STEAM OR HOT OIL**  
Giunti rotanti per vapore o olio diatermico



# N

## ROTARY UNIONS FOR STEAM OR HOT OIL Giunti rotanti per vapore o olio diatermico

The GIROL N series is divided into two categories:

- **FOR STEAM:** The rotary part and flange are made of stainless steel.
  - **FOR HOT OIL:** The entire rotary union is made of cast iron.
- For both categories, the seal and bearings are made with impregnated graphite. The housing, a fixed part, has cylindrical BSP thread while the shaft, the rotary part, has conical BSP thread.

I giunti GIROL della serie N si suddividono in due categorie:

- **PER VAPORE:** la fornitura standard prevede che la parte rotante e la flangia di chiusura siano in acciaio inox.
- **PER OLIO DIATERMICO:** la fornitura standard prevede che il materiale costruttivo sia interamente in ghisa. Per entrambe le categorie la tenuta sferica e i cuscinetti sono in grafite impregnata, le filettature GAS cilindriche per la parte fissa (corpo) e GAS conica per la parte rotante (rotore).

### MAX FLUID PRESSURE

- ▶ STEAM - WATER - HOT OIL  
Up to 25 bar



### MAX SPEED

- ▶ Up to 500 rpm
- ▶ Above 500 rpm contact Tech Dept

### MAX TEMPERATURE

- ▶ STEAM - WATER - HOT OIL 316 °C

# MONOFLOW VERSION

## Versione monovia

# NB

①

### FLANGED VERSION

Versione attacco a flangia

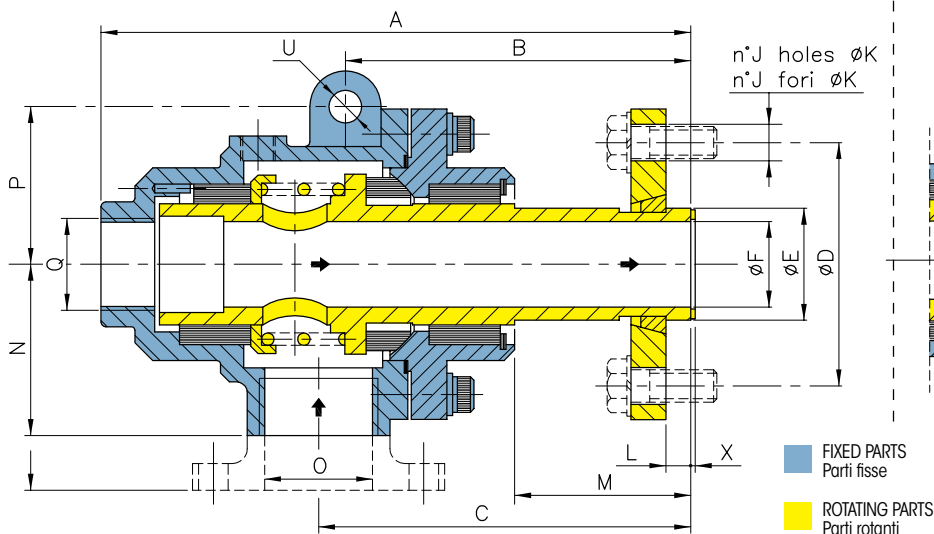

②

### THREAD VERSION

Versione filettata

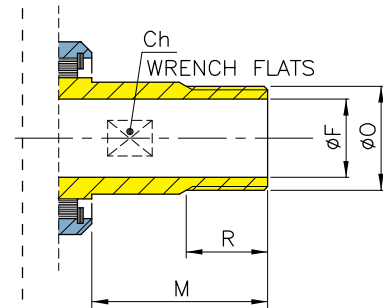

For left thread, the third letter of code change replacing "D" with "S"  
Per filettature sinistre, la terza lettera del codice varia sostituendo "D" con "S"

STEAM - THERMAL OIL Vapore - Olio Diatermico		A	B	C	D	E	F	J	K	L	M	N	O	P	Q	R	Ch	U
②	NBD050-GF3KX	137	82	90	/	/	19	/	/	/	40 1,57	40	1/2" BSP	38	1/2" BSP	18	24	10
②	NBD075-GF3KX	137	82	90	/	/	19	/	/	/	40	40	3/4" BSP	38	1/2" BSP	18	24	10
①	NB0075-GF3LX	137	82	90	75	26	19	4	14	11	1,57	40	3/4" BSP	38	1/2" BSP	/	/	10
②	NBD100-GF3KX	163	99	108	/	/	24	/	/	/	49	48	1" BSP	46	3/4" BSP	18	30	12
①	NB0100-GF3LX	163	99	108	85	32,5	24	4	14	11	1,92	48	1" BSP	46	3/4" BSP	/	/	12
②	NBD125-GF3KX	183	106	115	/	/	32	/	/	/	50	60	1" 1/4 BSP	58	1" BSP	23	40	12
①	NB0125-GF3LX	183	106	115	85	41,3	32	4	14	12,5	1,96	60	1" 1/4 BSP	58	1" BSP	/	/	12
②	NBD150-GF3KX	200	119	134	/	/	38	/	/	/	55	63	1" 1/2 BSP	60	1" 1/4 BSP	24	46	14
①	NB0150-GF3LX	200	119	134	100	47,5	38	4	18	12,5	2,16	63	1" 1/2 BSP	60	1" 1/4 BSP	/	/	14
②	NBD200-GF3KX	236	135	155	/	/	49	/	/	/	62	75	2" BSP	70	1" 1/2 BSP	25	58	16
①	NB0200-GF3LX	236	135	155	125	59,1	49	4	18	16	2,44	75	2" BSP	70	1" 1/2 BSP	/	/	16
②	NBD250-GF3KX	271	152	175	/	/	62	/	/	/	68,5	90	2" 1/2 BSP	81	2" BSP	32	73	18
①	NB0250-GF3LX	271	152	175	125	72,2	62	4	18	19	2,69	90	2" 1/2 BSP	81	2" BSP	/	/	18
②	NBD300-GF3KX	308	165	194	/	/	72	/	/	/	73	103	3" BSP	90	2" 1/2 BSP	33	83	20
①	NB0300-GF3LX	308	165	194	160	87,3	72	8	18	22	2,87	103	3" BSP	90	2" 1/2 BSP	/	/	20
①	NB0400-LF1LF	338	189	213	180	112,7	95	8	18	25	85 3,34	160	DN100	115	/	/	/	25
①	NB0500-LF1LF	417	222	257	240	139,2	122	8	22	32	96 3,78	200	DN125	140	/	/	/	30
①	NB0600-LF1LF	498	248	291	270	168	146	8	22	32	103 4,05	220	DN150	162	/	/	/	35
①	NB0800-LF1LF	673	317	363	295	/	200	12	22	60	113 4,44	250	DN200	210	/	/	/	40

## DUAL FLOW UNIONS - FIXED SYPHON TUBE

Giunti a due vie - Tubo sifone fisso

1

### FLANGED VERSION Versione attacco a flangia

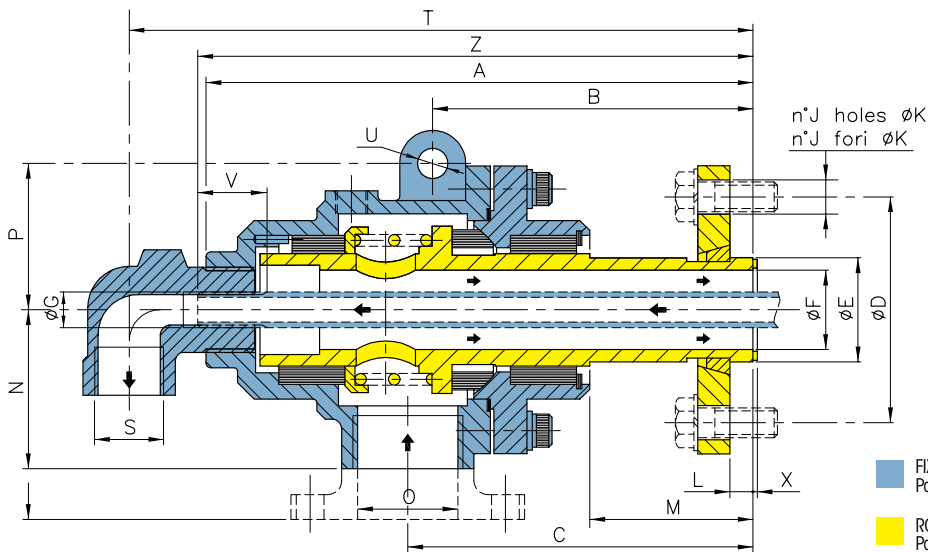

2

### THREAD VERSION Versione filettata

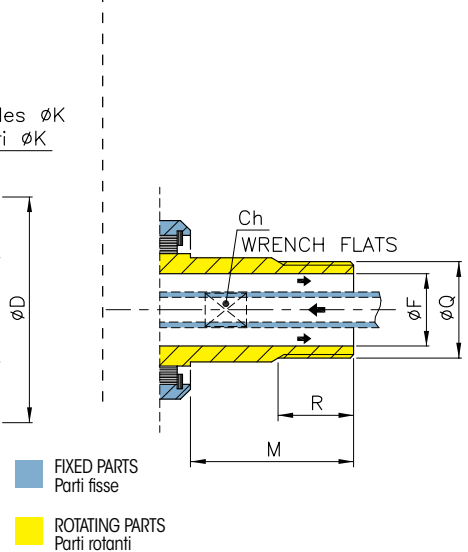

FIXED PARTS  
Parti fisse

ROTATING PARTS  
Parti rotanti

### Threaded pipe

The elbow of NF series help to support the syphon and it will be screwed in the elbow. The thread must be concentric of rotating union's axis for avoid misalingment

### Tubo filettato

La curva dei giunti serie NF fa da supporto al tubo sifone, il quale si avvita su di essa. Il filetto deve essere concentrico all'asse del giunto per evitare disassamenti rispetto all'asse del rullo

For left thread, the third letter of code change replacing "D" with "S"  
Per filettature sinistre, la terza lettera del codice varia sostituendo "D" con "S"

	STEAM - THERMAL OIL Vapore - Olio Diatermico	G	G1 (opt.)	T	V	Z
2	NFD052-GF3KX	1/8" BSP	1/4" BSP	150	15	137
2	NFD077-GF3KX	1/4" BSP	1/8" BSP	169	15	159
1	NF0077-GF3LX					
2	NFD102-GF3KX	3/8" BSP	1/4" BSP	202	17	187
1	NF0102-GF3LX					
2	NFD127-GF3KX	1/2" BSP	3/8" BSP	232	20	212
1	NF0127-GF3LX					
2	NFD152-GF3KX	3/4" BSP	1/2" BSP	256	25	231
1	NF0152-GF3LX					
2	NFD202-GF3KX	1" BSP	3/4" BSP	296	25	271
1	NF0202-GF3LX					
2	NFD252-GF3KX	1 1/4" BSP	1" BSP	337	28	307
1	NF0252-GF3LX					
2	NFD302-GF3KX	1 1/2" BSP	2 1/4" BSP	387	30	347
1	NF0302-GF3LX					
1	NB0402-LF1LF	2" BSP	DN 65	464	35	343
1	NB0502-LF1LF	2 1/2" BSP	DN 80	567	60	420
1	NB0602-LF1LF	3" BSP	DN 100	685	70	500
1	NB0802-LF1LF	4" BSP	DN 125	723	150	615

# DUAL FLOW UNIONS - FREELY ROTATING SYPHON TUBE

## Giunti a due vie - Tubo sifone rotante libero

# NR

1

### FLANGED VERSION Versione attacco a flangia

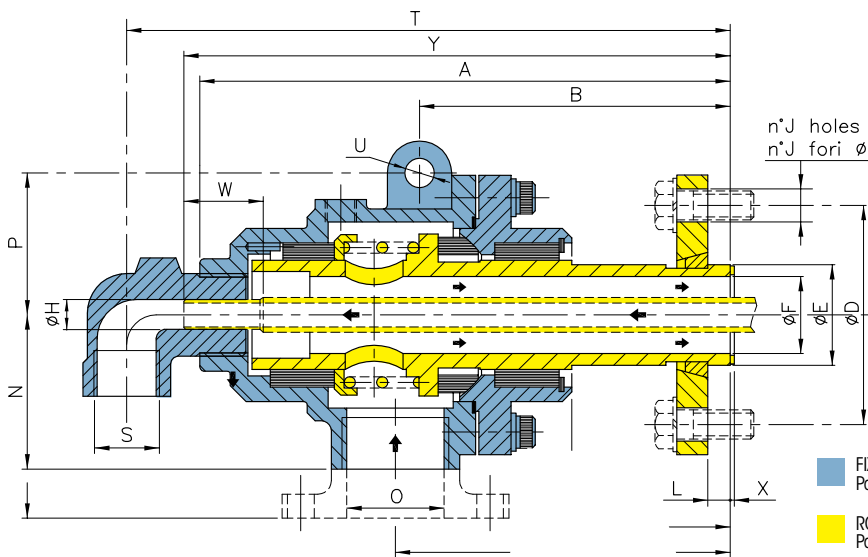

2

### THREAD VERSION Versione filettata

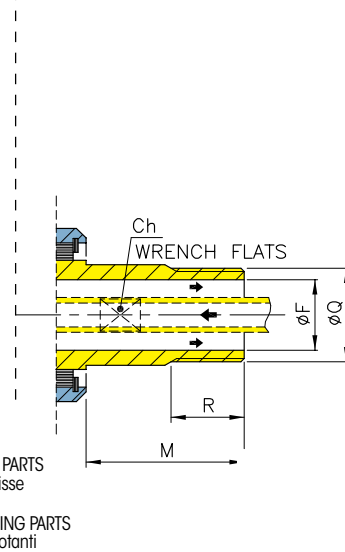

For left thread, the third letter of code change replacing "D" with "S"  
Per filettature sinistre, la terza lettera del codice varia sostituendo "D" con "S"

	STEAM - THERMAL OIL Vapore - Olio Diatermico	H	S	T	V	Y
2	NRD052-GF3KX	9	1/4" BSP	150	15	137
2	NRD077-GF3KX	12	3/8" BSP	169	15	159
1	NR0077-GF3LX					
2	NRD102-GF3KX	16	1/2" BSP	202	17	187
1	NR0102-GF3LX					
2	NRD127-GF3KX	20	3/4" BSP	232	20	212
1	NR0127-GF3LX					
2	NRD152-GF3KX	25	1" BSP	256	25	231
1	NR0152-GF3LX					
2	NRD202-GF3KX	32	1" 1/4 BSP	296	25	271
1	NR0202-GF3LX					
2	NRD252-GF3KX	40	1" 1/2 BSP	337	28	307
1	NR0252-GF3LX					
2	NRD302-GF3KX	45	2" BSP	387	30	347
1	NR0302-GF3LX					
1	NR0402-LF1LF	58	DN 65	464	35	343
1	NR0502-LF1LF	75	DN 80	567	60	420
1	NR0602-LF1LF	87	DN 100	685	70	500
1	NR0802-LF1LF	112	DN 125	723	150	615

## ROTARY SYPHON WITH SEAL

### Tubo sifone rotante con tenuta

# NT

For NT series it's the same for NR series, but in the elbow there is one seal for double independent passage

Per la serie NT vale lo stesso discorso della serie NR, ma con la differenza che nella curva è presente una guarnizione che consente di avere due vie indipendenti.

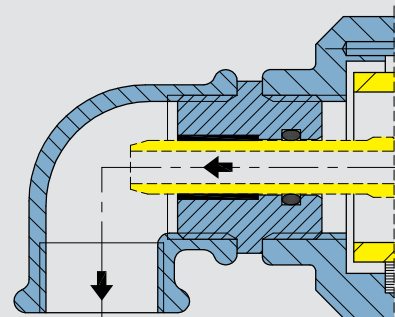



# INSTALLATION

Installazione

## HOW TO INSTALL // COME INSTALLARE

1

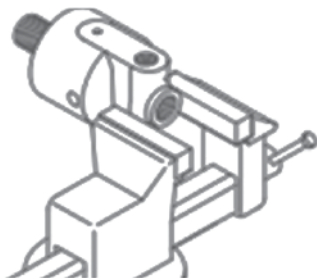

2

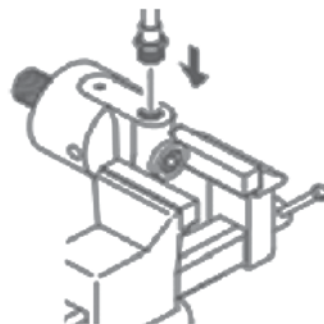

3



4

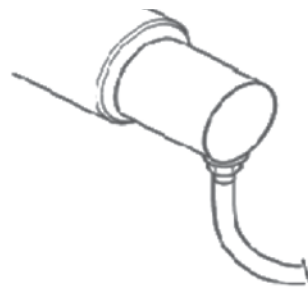

## HOW TO **NOT** INSTALL // COME **NON** INSTALLARE

1

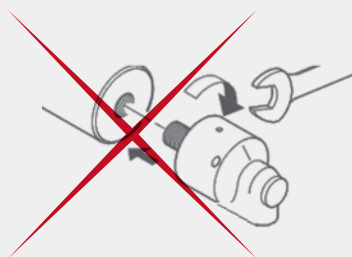

2



3

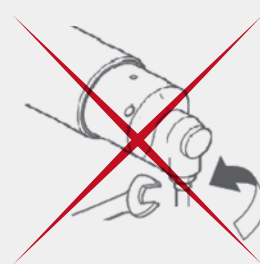

**PIPES MUST BE FLEXIBLE!**  
**ITUBI DEVONO ESSERE FLESSIBILI**